

# F90-558

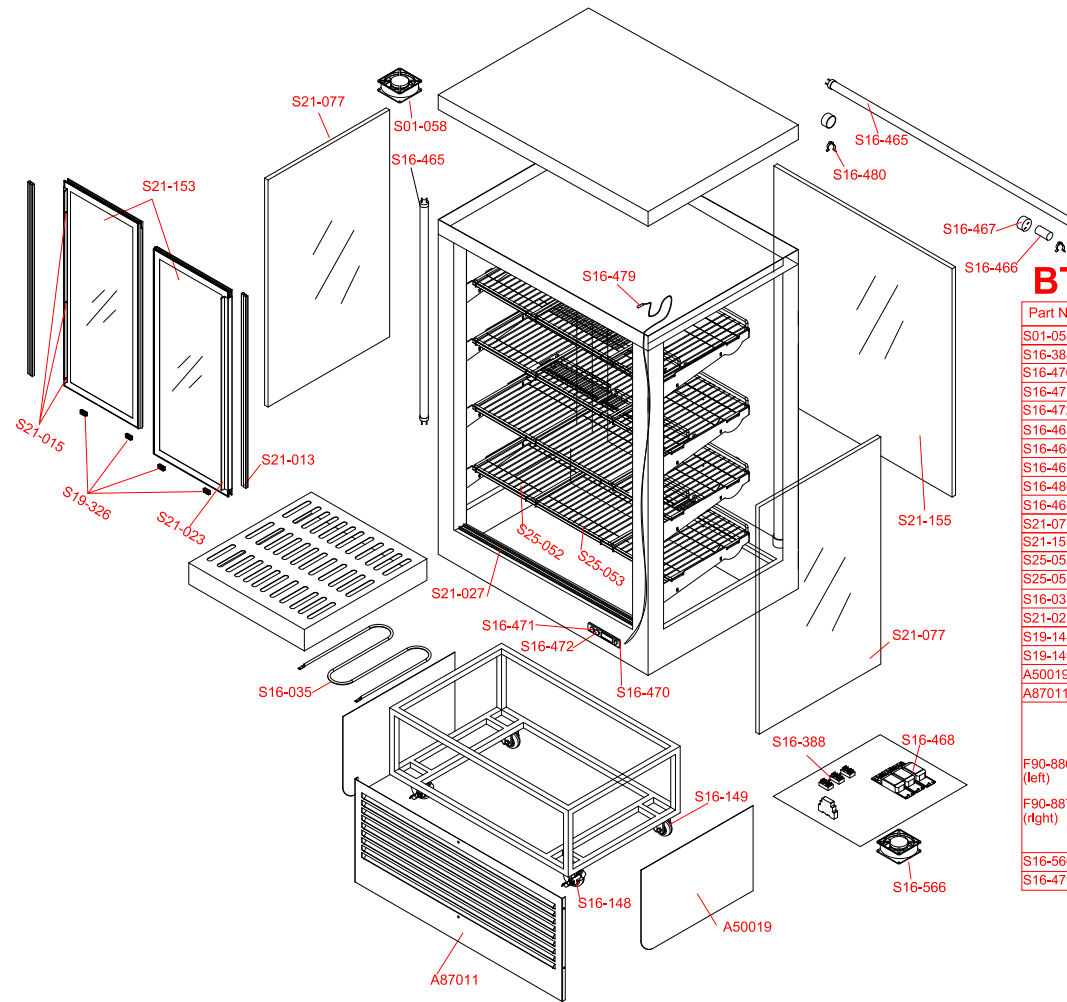

## BTHT9 Part list

| Part No         | Name                              | Qty |
|-----------------|-----------------------------------|-----|
| S01-058         | BLOWER                            | 1   |
| S16-388         | TERMINAL BLOCK                    | 3   |
| S16-470         | THERMOSTAT                        | 1   |
| S16-471         | POWER SUPPLY BUTTOM               | 1   |
| S16-472         | LAMP BOTTOM                       | 1   |
| S16-465         | LAMP                              | 3   |
| S16-466         | STARTER                           | 3   |
| S16-467         | LAMP HOLDER                       | 3   |
| S16-480         | LAMP CLIP                         | 6   |
| S16-468         | BALLAST                           | 3   |
| S21-077         | SIDE GLASS                        | 2   |
| S21-155         | GLASS PANEL,FRONT                 | 1   |
| S25-052         | WIRE SHELF                        | 8   |
| S25-053         | WIRE SHELF                        | 4   |
| S16-035         | HEATER                            | 1   |
| S21-027         | ROLLER GUIDE                      | 1   |
| S19-148         | CASTOR C/W BREAK                  | 2   |
| S19-149         | CASTOR                            | 2   |
| A50019          | SIDE PLATE                        | 2   |
| A87011          | FRONT SHUTTER                     | 1   |
|                 | S21-023 DOOR HANDLE, REAR GLASS   | 2   |
|                 | S21-028 GLASS FRAME               | 2   |
|                 | S21-153 GLASS REAR SLIDING PANEL  | 2   |
| F90-886 (left)  | S19-326 DOOR ROLLER,SLIDING GLASS | 4   |
|                 | S21-015 PVC STOPPER               | 3   |
| F90-887 (right) | S21-013 RUBBER SEAL SLIDING GLASS | 2   |
|                 | S99-007 SEAL                      | 4   |
|                 | S21-004 LABEL                     | 1   |
| S16-566         | BLOWER                            | 1   |
| S16-479         | Sensor                            | 1   |